



PHA 2000 SB Exit Pad SB

in Contur Design

Panic Hardware

The modular DORMA Panic Hardware-system in Contur Design

Prior knowledge of how to open the escape door is not expected.

DANGER OF PANIC

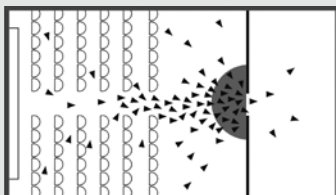

EN 1125

Panic exit devices operated
by a horizontal bar

DORMA PHA 2000 SB



Approval certification

The Panic Hardware products of the serie DORMA PHA 2000 has been tested to and certified compliant with EN 1125. All products meet the requirements of Annex ZA to EN 1125 and are therefore qualified to bear the **CE** mark of conformity.

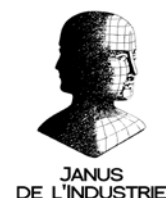

Prior knowledge of how to open the escape door is expected.

NO DANGER OF PANIC

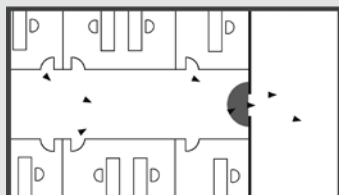

EN 179

Emergency escape devices with exit pad

Advanced, high-spec fittings for emergency exit doors

With this system, DORMA is able to offer a comprehensive range of high-quality panic hardware fittings with horizontal and vertical locking for doors in emergency exits and escape routes – applications in which safety, reliability and aesthetic attractiveness are indispensable requirements. DORMA's PHA products cover in full the hardware requirements that arise in

public-frequented facilities such as hospitals, universities and schools, concert halls, shopping malls, hotels and administrative buildings. Whether office suites or apartment blocks, in buildings where there is generally no public pedestrian traffic, the DORMA Exit Pad provides the ideal answer. For both series, the same external DORMA PHT fittings are used.

DORMA Exit Pad SB

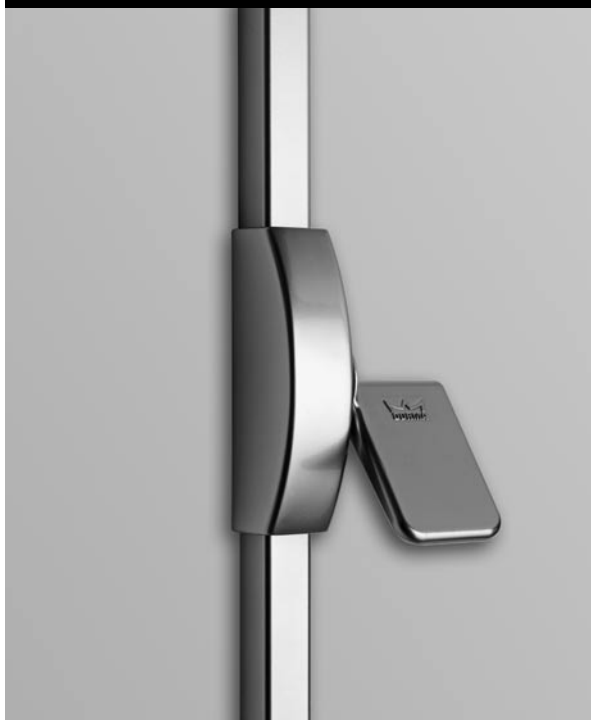

Approval certification

The emergency exit devices of the DORMA Exit Pad series are tested to and certified compliant with EN 179. All products meet the requirements of Annex ZA to EN 179 and are therefore qualified to bear the **CE** mark of conformity.

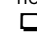

Additional information on many products can be viewed and retrieved at www.dorma.com

The abbreviated designations next to the computer symbol  indicate the search terms.

Contents

	Page
DORMA PHA 2000 SB	
Features and functions	4
DORMA PHA 2000 SB	
Dimensions	5
DORMA PHA 2000 SB	
Application and fixing details	6
DORMA PHA 2000 SB	
Components	7
DORMA Exit Pad SB	
Features and functions	8
DORMA Exit Pad SB	
Dimensions	9
DORMA Exit Pad SB	
Applications and fixing details	10
DORMA Exit Pad SB	
Components	11
DORMA PHT external fittings	12

Forward-looking and innovative hardware for escape doors

The DORMA Panic bolt represents high-quality Panic Hardware fittings for use on escape doors where security and reliability are crucial elements. With its top and bottom metal covers the PHA 2000 SB also fulfills requirements for aesthetic elegance and highest protection against vandalism.

DORMA Panic bolts fully meet the demands that are made on fittings used in public buildings, for example, in hospitals, universities and schools, concert halls, shopping centres, hotels and offices. To provide access from the outside the DORMA PHT external fittings can be used. All products are tested to EN 1125 and carry the **CE** mark.

Benefits

For the trade

- Complete packaging for easy handling
- Non-handed version
- Universal use of PHT external fittings

For the installer

- Straightforward fixing
- Easy adjustment to different door widths and heights

For the architect/specifier

- Metal covers for top and bottom rods
- Invisible fixings on all devices
- External fitting with DORMA Premium lever handle or knob.

For the user

- Simple operation
- Top and bottom shoot bolts for a high grade of security
- Excellent quality ensures secure retraction of the shoot bolts

Approval certification

The DORMA Panic bolt has been tested and approved to EN 1125 and carries the **CE** conformity mark in accordance with supplement ZA to that Standard.

F Approval certification

The DORMA Panic Hardware Series PHA 2220 products are CERTIFIRE approved (Certificate No. CF 318) for door types ITT 60, IMM/MM 240. Certificates are available on request.

Data and features	PHA 2000 SB
Standard doors (single-leaf/double-leaf)	●
Fire and smoke check doors (single-leaf/double-leaf) F	●
Door width	● ≤ 1000 mm ○ ≤ 1300 mm
Door height	● ≤ 2270 mm ○ ≤ 3400 mm ¹⁾
Max. door leaf weight in kg	200
Non-handed design	●
Dogging device ²⁾	●
Monitoring switch on actuating bar	○
PHT external fittings	
For standard doors and fire and smoke check doors	●
For door leaf thickness up to 60 mm	
Extended handle spindle and bolts for door leaf thickness of 60 – 105 mm	○
Approved to EN 1125	●
CE mark for construction products	●

● = Yes – = No ○ = option

¹⁾ Door higher than 2500 mm lie outside the scope of EN 1125.

²⁾ Not for fire and smoke check doors.

Approval certification

The DORMA Panic bolt has been tested and approved to EN 1125 and carries the **CE** conformity mark in accordance with supplement ZA to that Standard.

F Approval certification

The DORMA Panic Hardware Series PHA 2220 products are CERTIFIRE approved (Certificate No. CF 318) for door types ITT 60, IMM/MM 240. Certificates are available on request.

Dogging device

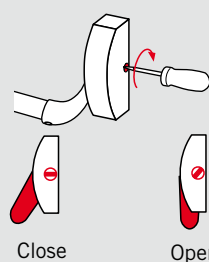

The dogging device serves to hold the latch in its retracted position, so the door is freely accessible.

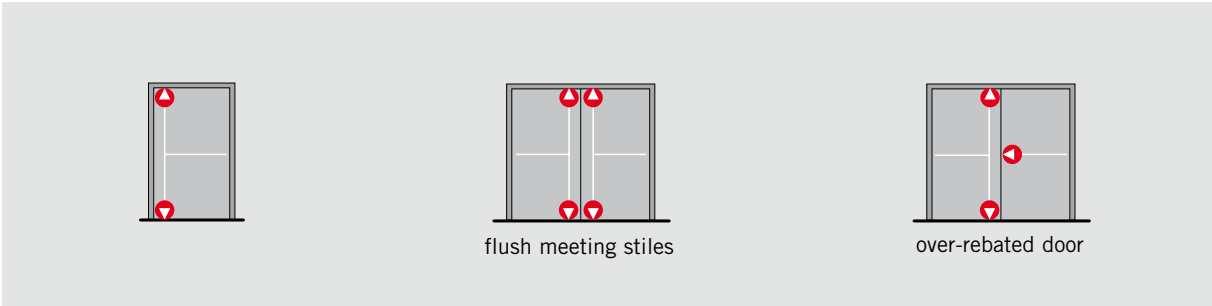

PHA 2000 SB dimensions

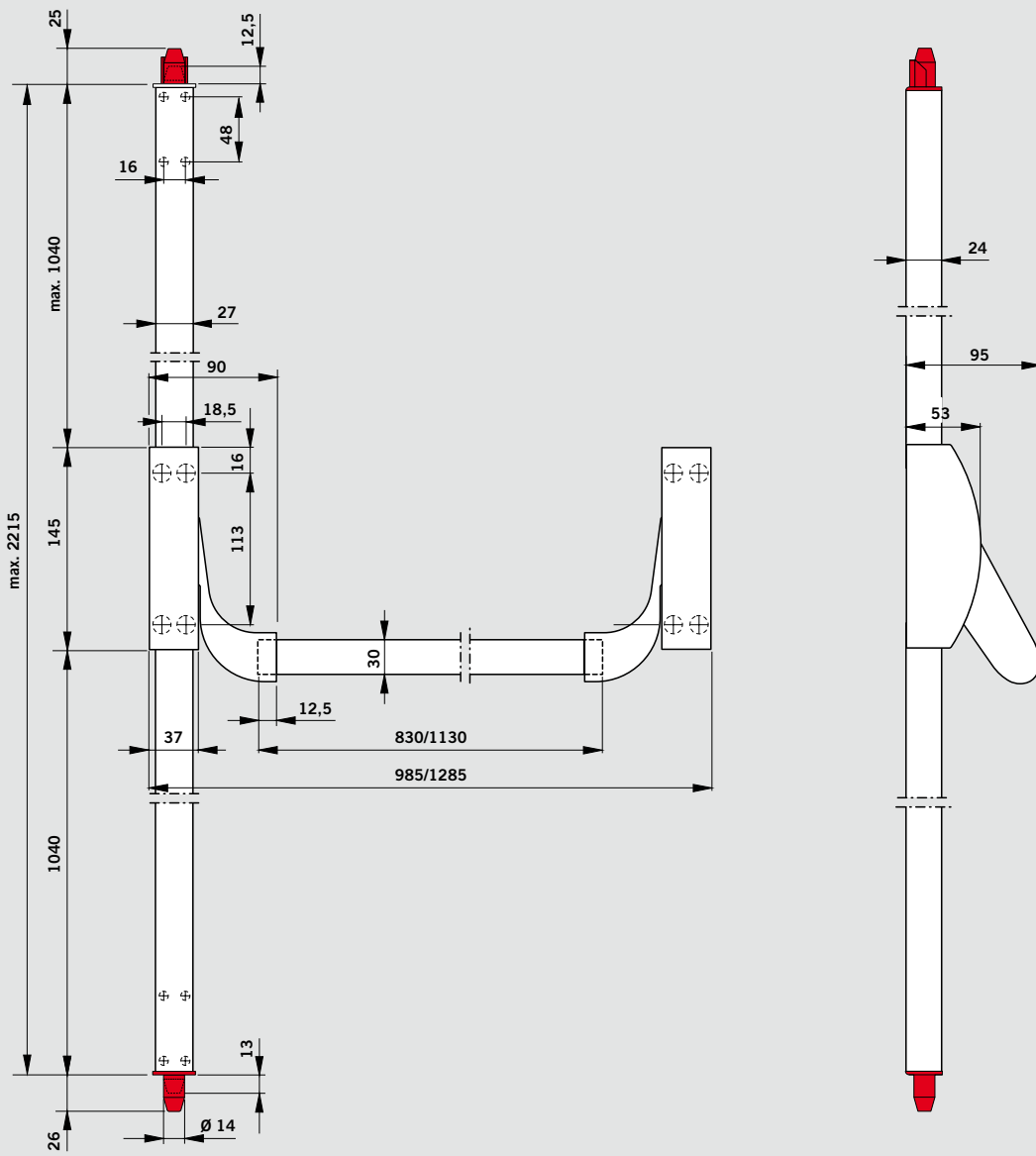

Applications and fixing details

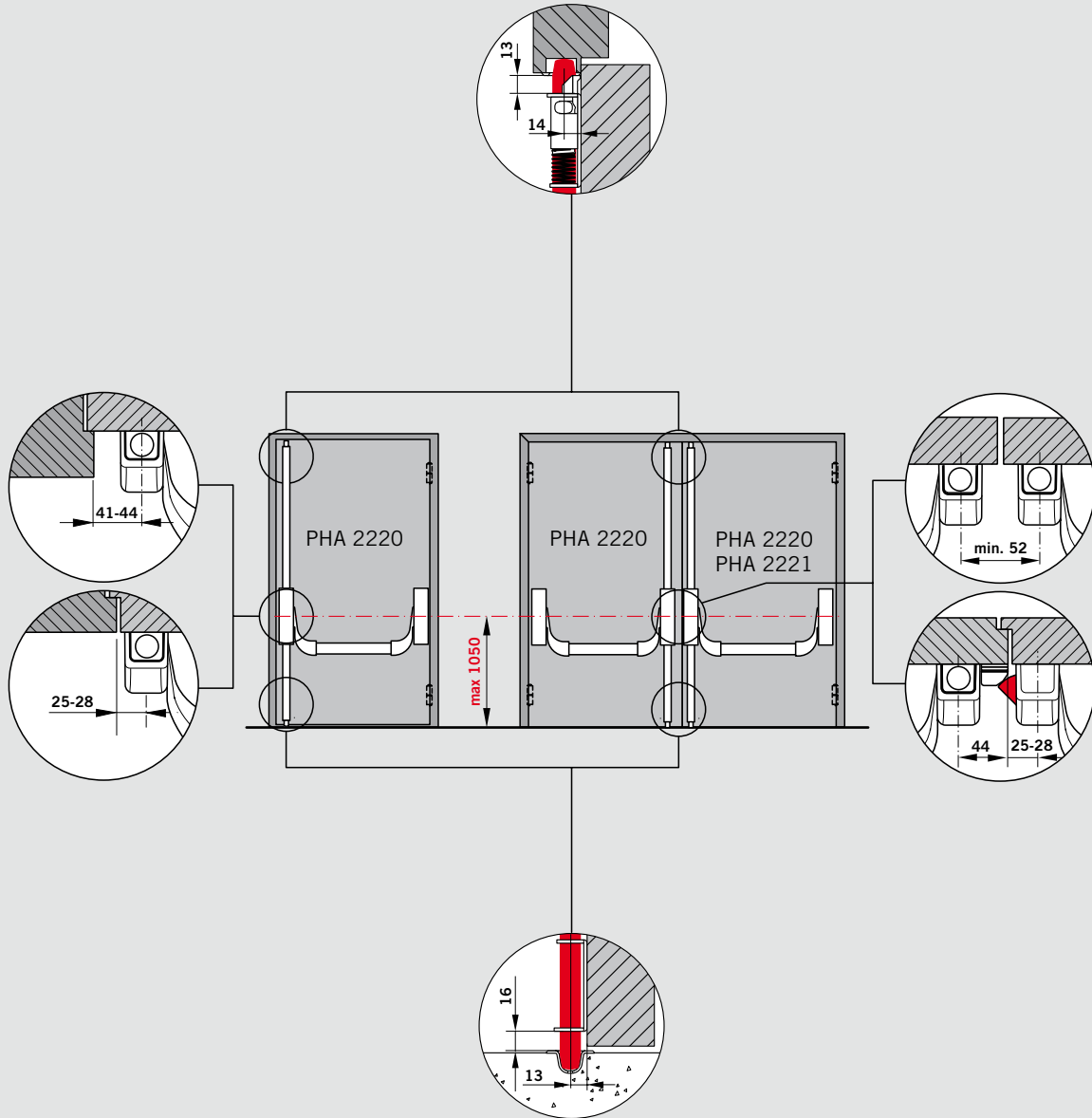

Note:

It may be the case that the panic fitting cannot be installed on extreme door situations according to standard measurements (door width X smaller than

1000 mm in connection with the distance of the hinge Y bigger than 90 mm). On request DORMA will gladly give you installation suggestions.

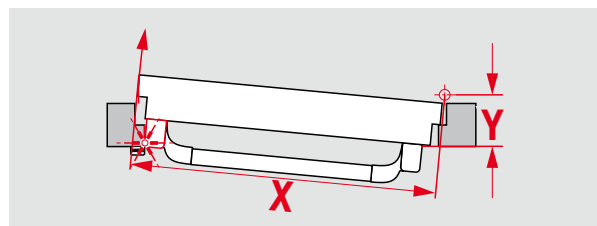

Specification text

Order no. 35014 .. 

PHA 2000 SB, Panic bolt series

Panic door bolt tested in accordance with EN 1125, for door widths up to 1000 mm, door heights up to 2270 mm (in accordance with EN 1125) or 3400 mm; non-handed. All products carry the  mark.

PHA 2220 

Two-point locking, for fire and smoke check doors, with steel top and bottom shoot bolts, operation bar 830 mm (for door widths up to 1000 mm). Connecting rod set with metal covers for door heights up to 2270 mm. With dogging device and keeps. Silver finish

..22201001  PHA 2220

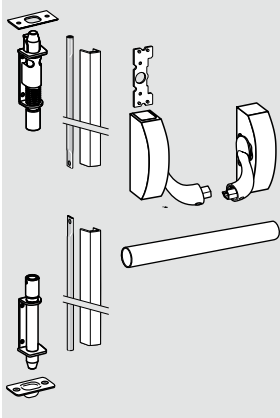

For double-doors, over-rebated – active leaf

PHA 2221 

Single-point locking, for fire and smoke check doors, with dogging device. Steel latch, latch keep with spacer plates. Silver finish

..22211001  PHA 2221

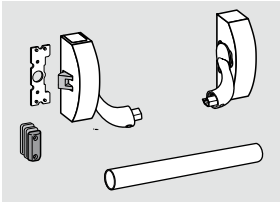

PHA 2105

Connecting rod 1130 mm (for door widths up to 1300 mm) Silver finish

..21051001  PHA 2105

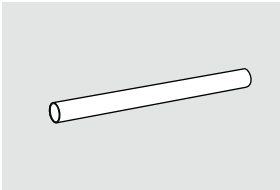

PHA 2225

Connecting rod set with covers for door heights up to 3400 mm. Silver finish

..22251001  PHA 2225

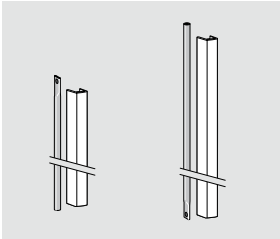

PHA Microswitch

For actuation of visual or audible signals. Contact rating: max. 48 V DC, max. 3 A

..25200060  PHA Accessories

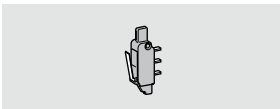

Emergency exits protected in accordance with EN 179

The fittings of the DORMA Exit Pad series are high-quality emergency exit devices for doors in escape routes. They are used in buildings with no public pedestrian traffic. It is expected that people using the building are familiar with the exits and their fittings, avoiding the likelihood of a panic situation developing.

All products of the DORMA Exit Pad series have been tested to and certified compliant with EN 179.

Data and features	Exit Pad SB
Standard doors (single-leaf/double-leaf)	●
Fire and smoke check doors (single-leaf/double-leaf) F	●
Door width ≤ 1300 mm	●
Door height ≤ 2270 mm	●
Max. door leaf weight in kg	200
Non-handed design	●
PHT external fittings For standard doors and fire and smoke check doors For door leaf thickness up to 60 mm	●
Extended handle spindle and bolts for door leaf thickness 60 – 105 mm	○
Approved to EN 1125	●
CE mark for construction products	●

● = Yes – = No ○ = option

Benefits

For the trade

- All-in-one packaging for easy stocking
- Non-handed
- Universal use of PHT external fittings

For the installer

- Straightforward fixing
- Easy adjustment to different door widths and heights

For the architect/specifier

- High-quality appearance with no visible fixings
- Connecting rods with metal covers
- External fitting with DORMA Premium lever handle or knob

For the user

- Simple operation
- Excellent quality ensures long lifespan

Approval certification

The DORMA Exit Pad Series has been tested and approved to EN 179 and carries the **CE** conformity mark in accordance with supplement ZA to that Standard.

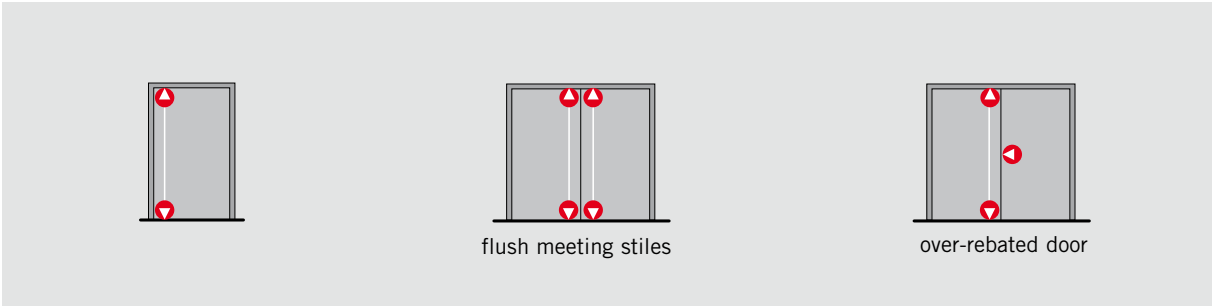

Exit Pad SB dimensions

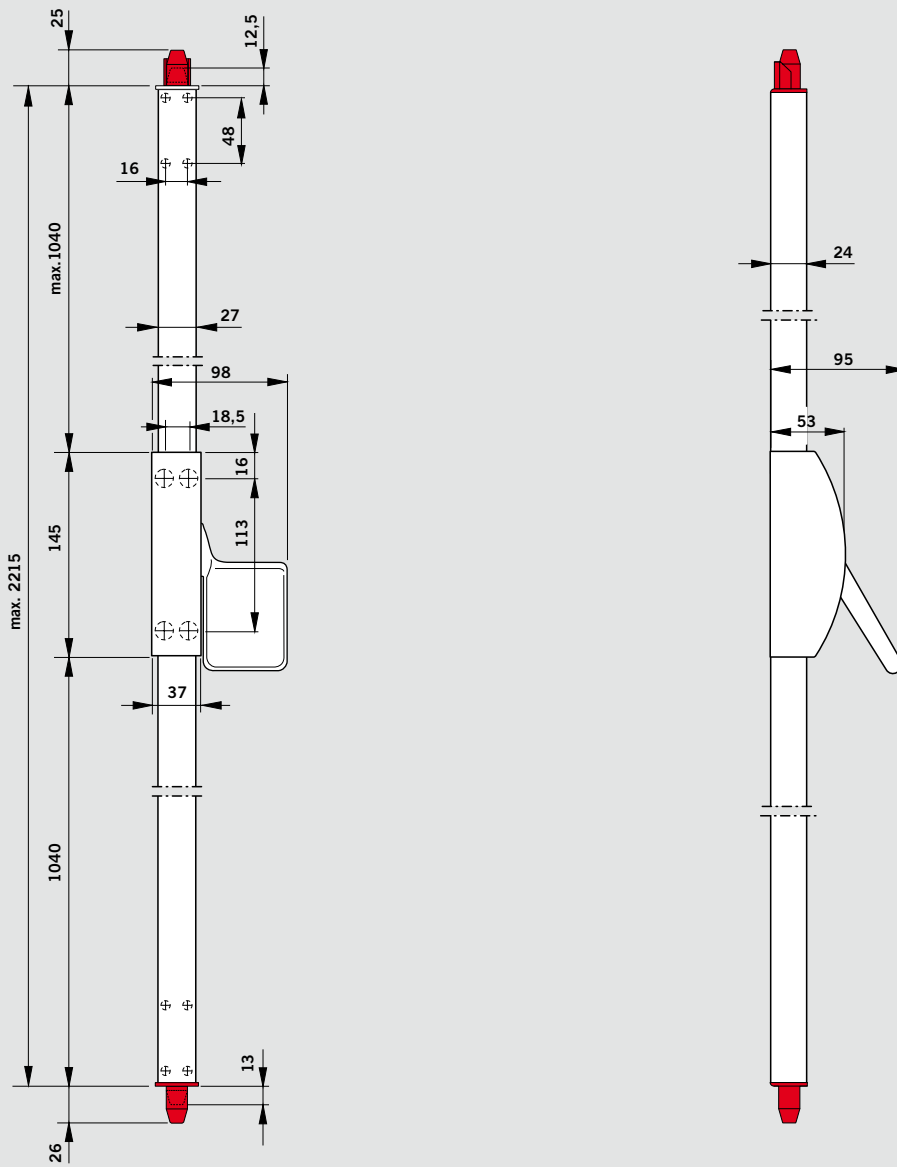

Applications and fixing details

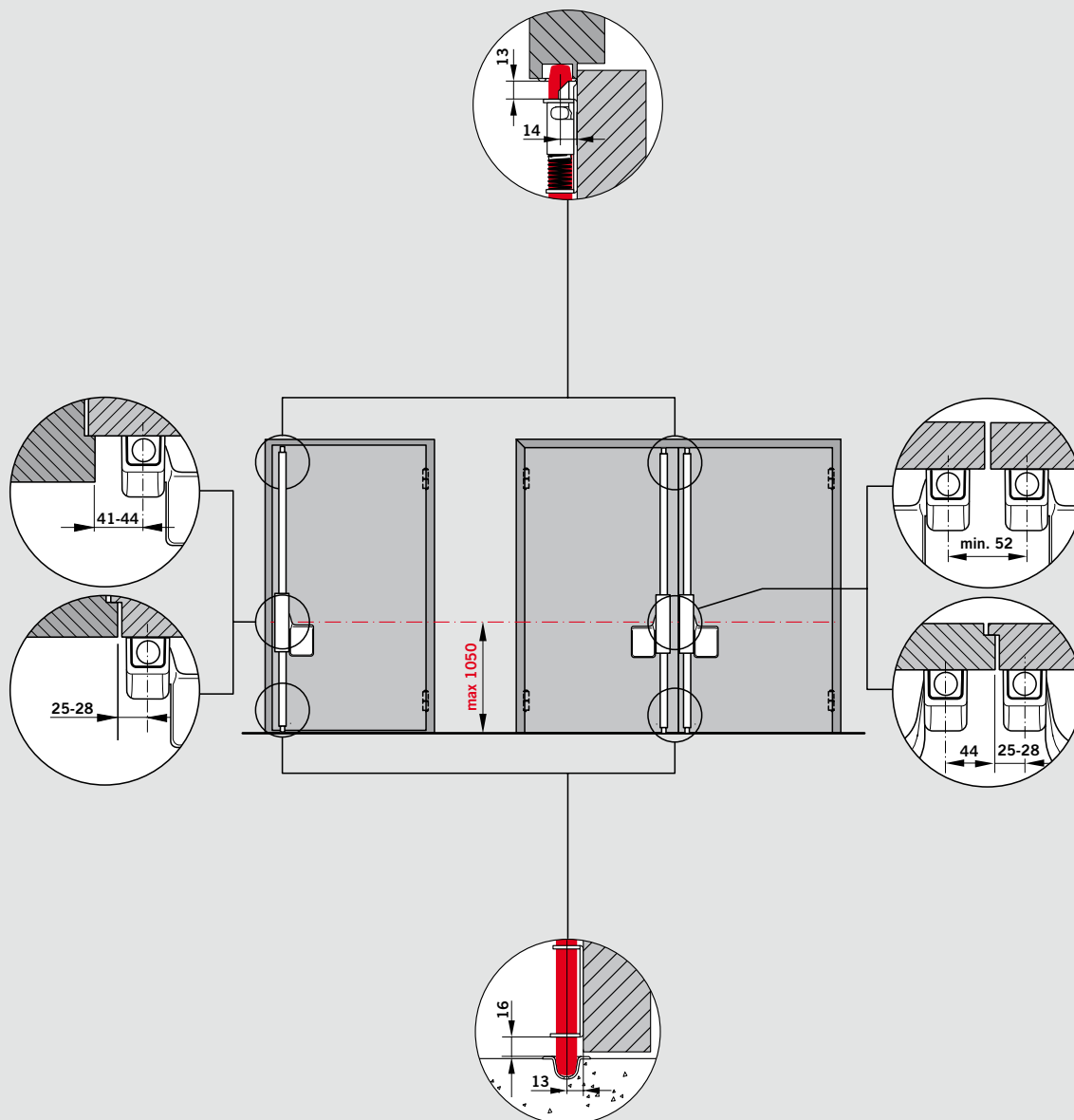

Note:

It may be the case that the exit device cannot be installed based on standard measurements where the door situation is extreme, e.g. with a door width

$X < 1000$ mm combined with a hinge offset $Y > 90$ mm. DORMA will be glad to provide you with installation suggestions on request.

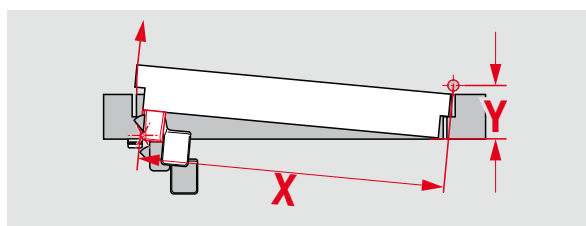

Specification text

Exit Pad tested in accordance with EN 179, non-handed.
All products carry the -mark.

Exit Pad F 2P SB

two-point locking, for fire and smoke check doors,
door heights up to 2270, with steel shoot bolts,
plastic mounting backplate.
Silver finish

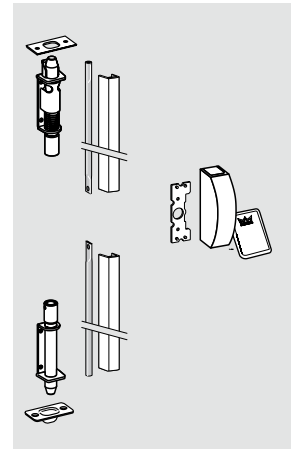
Order no. 35014 .. **..22300001**  Exit Pad

PHT – External Fitting

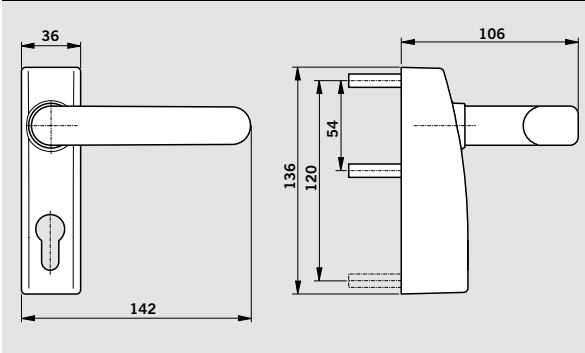

PHT 01, 03, 05 – External fitting with lever handle

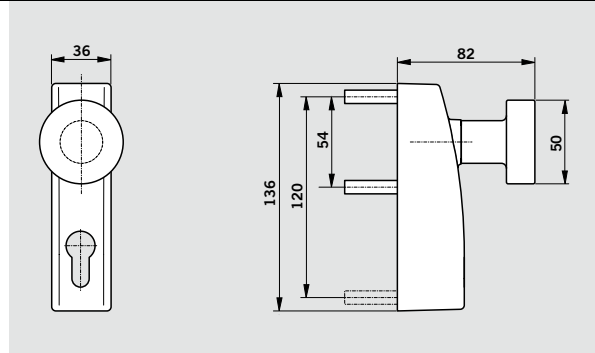

PHT 06 – External fitting with knob

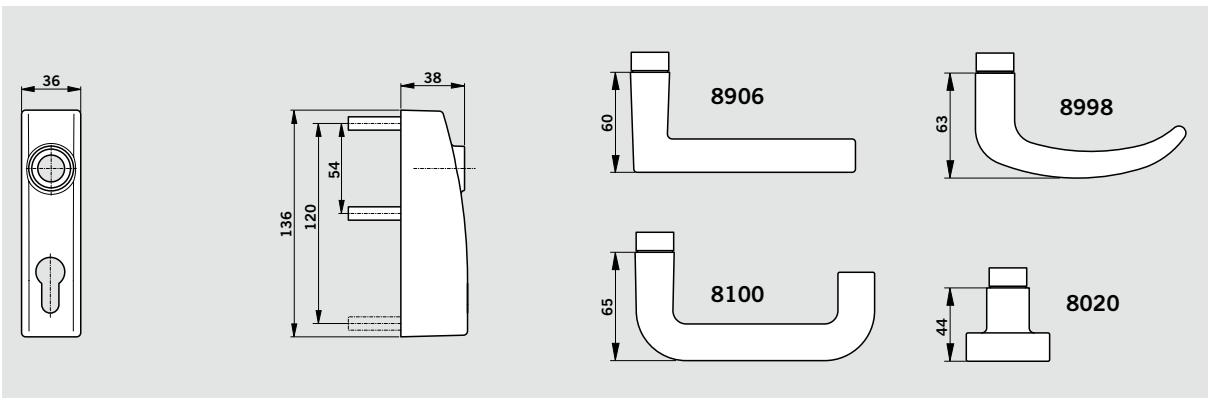

PHT 07 – External fitting, modular

F

When using the DORMA PHT external fitting in conjunction with PHA 2000 SB or Exit Pad SB on fire and smoke check doors, it must be ensured that the appropriate set of gaskets is used.

CE

The panic hardware products of the DORMA PHT series carry the **CE** mark of conformity.

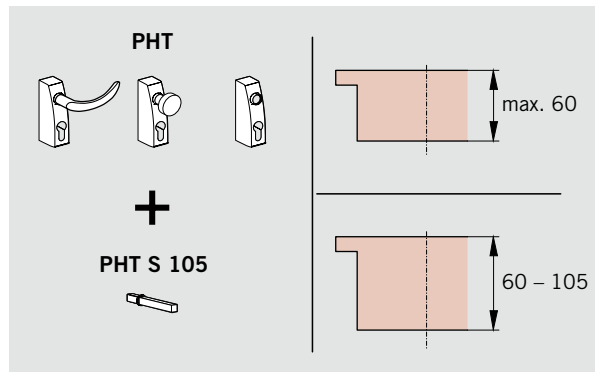

Specification text
Order No. 35014 .. 
PHT

External fitting with lever handle or knob, suitable for use with PHA 2000 SB and Exit Pad SB. All PHT external fittings are non-handed and carry the  mark.

PHT 01

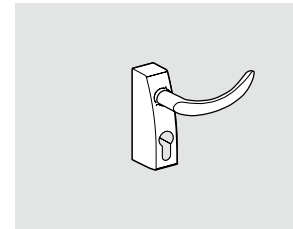

External fitting with DORMA Premium lever handle, for standard doors with a leaf thickness of up to 60 mm, prepared for installation of a Europrofile single cylinder. With lever handle spindle and two cylinder fixing bolts. Silver finish

..39011001  PHT 01

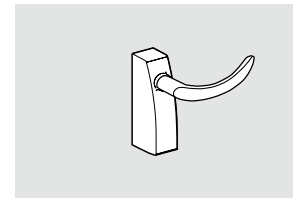

PHT 03

External fitting with DORMA Premium lever handle, for standard doors with a leaf thickness up to 60 mm, non-lockable. With lever handle spindle. Silver finish

..39031001  PHT 03



PHT 05 

External fitting with DORMA Premium lever handle for fire and smoke check doors with a leaf thickness up to 60 mm. With integrated ring gasket. Prepared for installation of a Europrofile single cylinder. With lever handle spindle and two cylinder fixing bolts. Silver finish

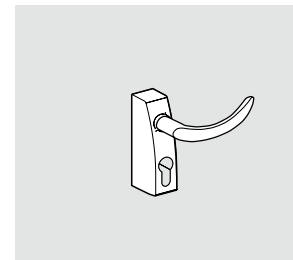
..39051001  PHT 05



PHT 06

External fitting with knob, for standard doors with a door thickness up to 60 mm, prepared for the installation of a Europrofile single cylinder. With lever handle spindle and two cylinder fixing bolts. Silver finish

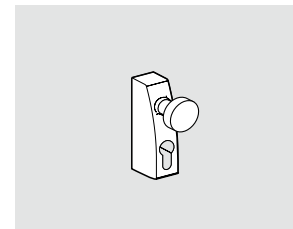
..39061001  PHT 06

PHT 07 

External fitting, suitable for combination with DORMA Premium lever handles or knobs for fire and smoke check doors. With lever handle spindle and two cylinder fixing bolts. Silver finish

..39071001  PHT 07

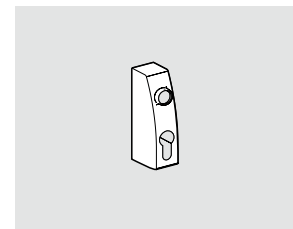

Specification text

PHT S 05 Extended Spindle

8 mm square, incl. fixing screws
for door leaf thicknesses of 60 – 105 mm.

F **Gasket Set** for external fitting
and **PHA 2000 SB/Exit Pad SB** fixed to
fire and smoke check doors.

DORMA TL-Z 03

Single Europrofile cylinder with 3 keys,
for PHT 01, 05, 06, 07

Order No. 35014 .. 

..39200050  PHT
Accessories

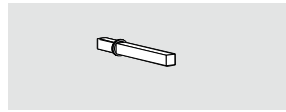

..39200060  PHT
Accessories

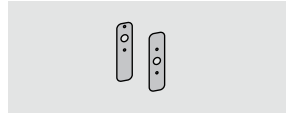

56510300

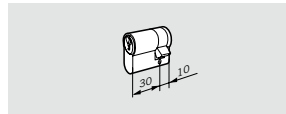



Door Control



Automatic



Glass Fittings and Accessories



Security/Time and Access (STA)



Movable Walls

Door Control Division worldwide

Central Europe

DORMA GmbH + Co. KG
DORMA Platz 1
D-58256 Ennepetal
Tel. +49 2333 793-0
Fax +49 2333 793-495

Australasia

DORMA Door Controls Pty. Ltd.
46-52, Abbott Road
Hallam/Victoria 3803
Australia
Tel. +61 3979 63555
Fax +61 3979 63955

China/Hong Kong

DORMA Door Controls
(Suzhou) Co. Ltd.
No. 9, Hong Feng Road
Suzhou Singapore Industrial Park
Suzhou, 215021
P.R. of China
Tel. +86 512 67612481
Fax +86 512 67614582

DORMA Door Controls Pte. Ltd.

Room 701, Technology Plaza
651 King's Road
North Point
Hong Kong
Tel. +852 25034632
Fax +852 28875370

Emerging Markets

DORMA GmbH + Co. KG
DORMA Platz 1
D-58256 Ennepetal
Tel. +49 2333 793-0
Fax +49 2333 793-495

DORMA Door Controls (Pty.) Ltd.

Kings Court
4A Mineral Crescent
ZA-2000 Crown/Gauteng
South Africa
Tel. +27 11 8300280
Fax +27 11 8300291

Far East

DORMA Far East Pte. Ltd.
No. 31 Gul Lane
Singapore 629425
Tel. +65 6268 7633
Fax +65 6265 7995

France

DORMA France S.A.S.
Europarc
42, rue Eugène Dupuis
F-94046 Créteil
Tel. +33 1 41942400
Fax +33 1 41942401

Gulf

DORMA Gulf Door Controls FZE
Jebel Ali Free Zone South
Plot No. S 20135
Road No. SW 301 G
P.O. Box 17268
Dubai – United Arab Emirates
Tel. +971 4 8020400
Fax +971 4 8869100/8869101

North America

DORMA Architectural Hardware
DORMA Drive, Drawer AC
Reamstown, PA 17567-0411
Tel. +1 800 5238483
Fax +1 800 2749724

Scanbalt

DORMA Sverige AB
F O Petersons Gata 24
SE-421 31 Västra Frölunda
Tel. +46 31 289520
Fax +46 31 281739

South America

DORMA Sistemas de Controles
para Portas Ltda.
Av. Piracema, 1400
Centro Empresarial Tambore
CEP 06400-933 Barueri/
São Paulo, Brasil
Tel. +55 11 46899280
Fax +55 11 46899215

South-East Europe

DORMA AUSTRIA GmbH
Pebering Strass 22
A-5301 Eugendorf
Tel. +43 6225 284880
Fax +43 6225 28491

South Europe

DORMA Italiana S.r.l.
Via. Canova 44/46
I-20035 Lissone (MI)
Tel. +39 039 244031
Fax +39 039 24403310

DORMA Ibérica, S.A.

Camino San Martin de la Vega, 4
E-28500 Arganda del Rey
(Madrid)
Tel. +34 91 8757850
Fax +34 91 8757881

UK/Ireland

DORMA UK Ltd.
Wilbury Way
Hitchin
GB-Hertfordshire SG4 0AB
Great Britain
Tel. +44 1462 477600
Fax +44 1462 477601



4 021 226 18 02 8 161